

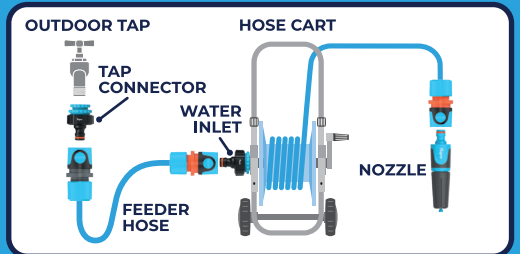

# HOW TO SET UP YOUR HOSE CART



## 1. ATTACH CART TO TAP

### STEP 1

Remove entire hose from cart



### STEP 2

Remove bag of fittings from inside the box

### STEP 3

Cut off required length of feeder hose to reach from tap to cart



### STEP 4

Use 1 x Water Stop & 1 x Supergrip Connector attached to each end of the feeder hose



### STEP 5

Screw outdoor tap connector to tap & attach feeder hose



### STEP 6

Screw on the Water Inlet and attach the feeder hose



## 2. ATTACH CART HANDLE

Line up and insert the towing handle into the holes at the side of the frame

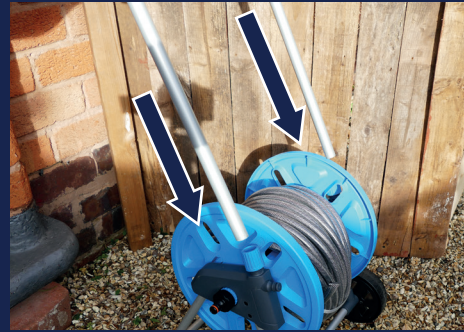

Adjust to required height and tighten to secure in position



Push in the Winding handle attachment until you hear it click



## 3. GET HOSE READY ON CART

### STEP 1

Push the spring into the centre of the inlet



### STEP 2

Thread inlet nut on hose and push over the spring



### STEP 3

Tighten until firmly fixed



### STEP 4

Remove nut from waterstop connector (orange body)



### STEP 5

Thread nut over hose & tighten the connector



### STEP 6

Attach nozzle with connector



### STEP 7

Wind hose back on cart



### STEP 8

Turn on tap when ready to use



## ATTACHING THE HOSE INSIDE THE DRUM

### STEP 1



### STEP 2

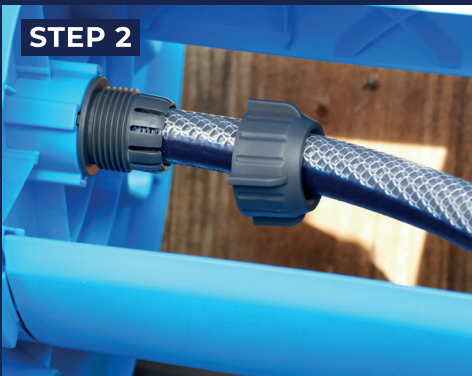

### STEP 3

